

Initiate a Connection in Script Mode for Jira Cloud

Last Modified on 12/08/2022 6:43 am EST

You cannot toggle between the different modes. To do so, you need to create a new Connection in Visual mode, Script mode, or Basic mode.

Before you set up a Connection in Script mode ensure that:

- your instance is public.
- you are either in the Evaluation (trial) period or have a Paid license.

Initiate a Connection in Script Mode from Jira Cloud

Attention:

It doesn't matter which side you start initiating the Connection from. The Exalate UI will remain the same.

If you are initiating the connection you become the source and the other side becomes the destination.

To establish a Connection in Script mode between two instances, you need to generate an **Invitation Code** on one instance and accept it on the other instance.

1. Navigate to the **Connections** tab in the Exalate console.

Click **Settings** → **Apps** & click **Connections** under the **Exalate** menu.

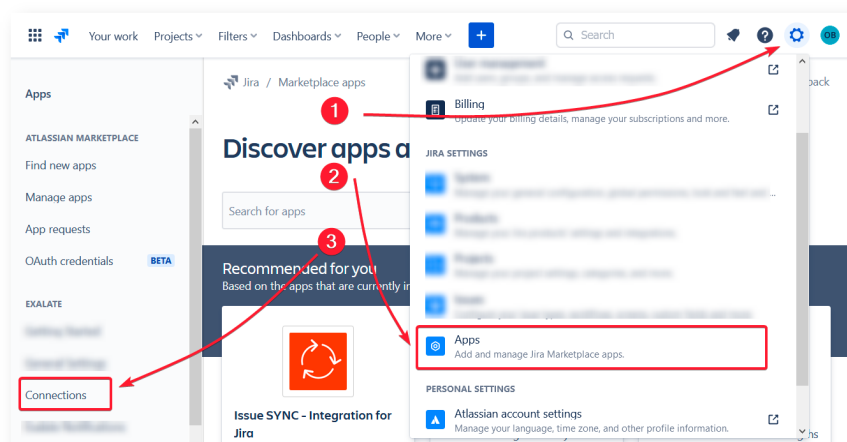

2. Click **Initiate Connection**.

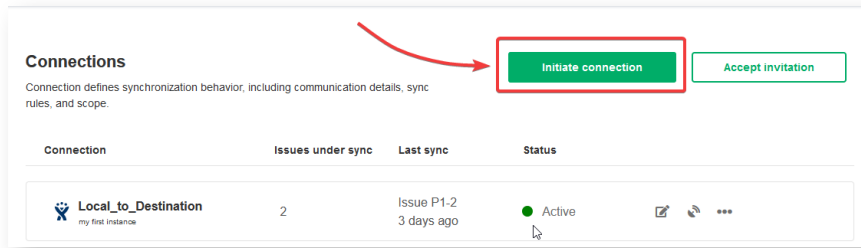

3. Enter the **Destination Instance URL**.

The **Destination Instance URL** is the link to the instance you want to set up a connection with. You can directly enter the link of that instance or the **Exalate URL** from the **General Settings** tab in the Exalate admin panel.

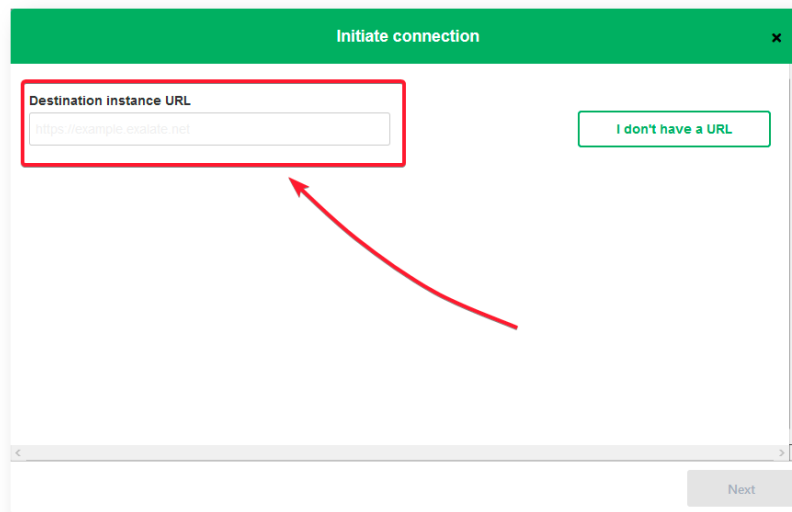

Exalate will suggest available Configuration Modes based on the destination instance.

4. Select the Configuration Mode. In this case, **Script** Mode.

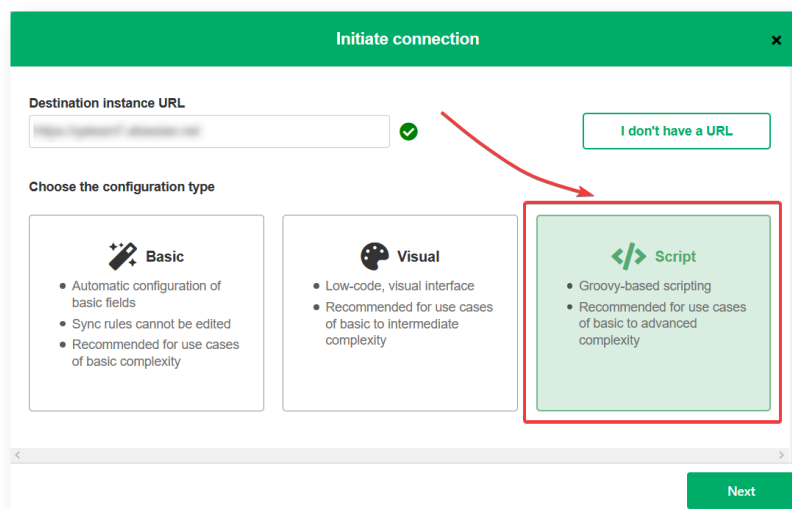

5. Click **Next**.

6. Enter the Connection Information

Field	Description
Local instance short name	A short name for your instance
Destination instance short name	A short name for the destination instance
Connection name	Name of the connection
Description	Description of the connection

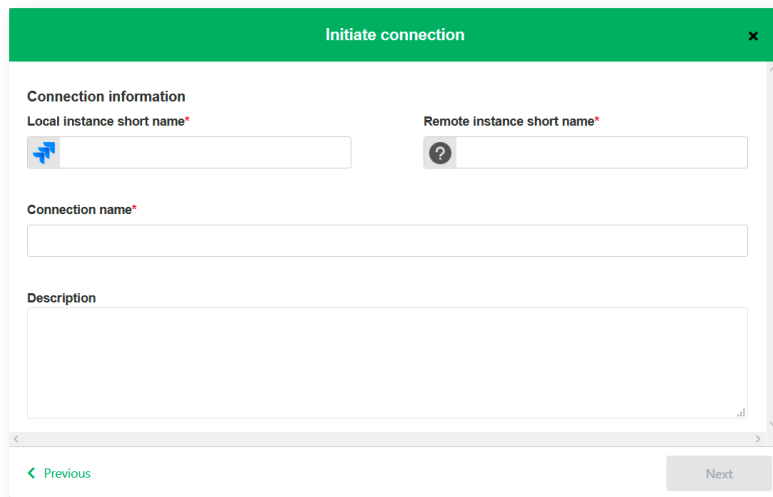

The screenshot shows a dialog box titled "Initiate connection" with a green header. The main content area is titled "Connection information" and contains four input fields: "Local instance short name*" (with a blue icon), "Remote instance short name*" (with a question mark icon), "Connection name*", and "Description". At the bottom, there are "Previous" and "Next" buttons.

7. Click **Next**.

8. Select a project where you would like to sync issues received from the destination side.

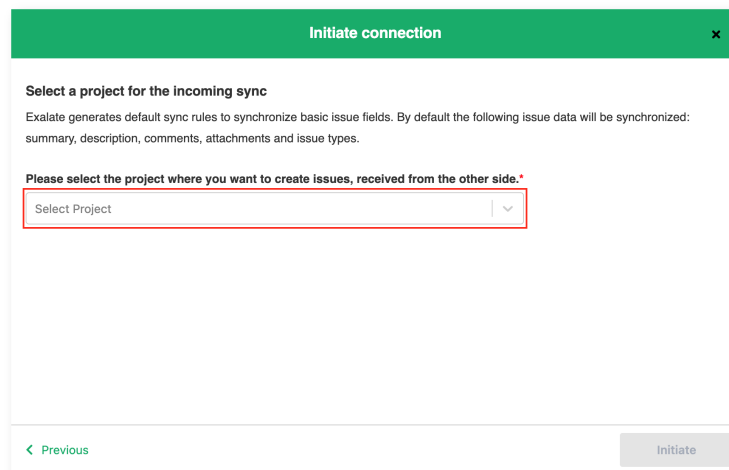

The screenshot shows the same "Initiate connection" dialog box, but now the "Select a project for the incoming sync" section is active. It includes a paragraph of text: "Exalate generates default sync rules to synchronize basic issue fields. By default the following issue data will be synchronized: summary, description, comments, attachments and issue types." Below this is a red-bordered instruction: "Please select the project where you want to create issues, received from the other side.*" and a dropdown menu labeled "Select Project". At the bottom, there are "Previous" and "Initiate" buttons.

9. Click **Initiate**.

10. Click **Copy invitation code**.

You can send the invitation code to the destination instance admin.

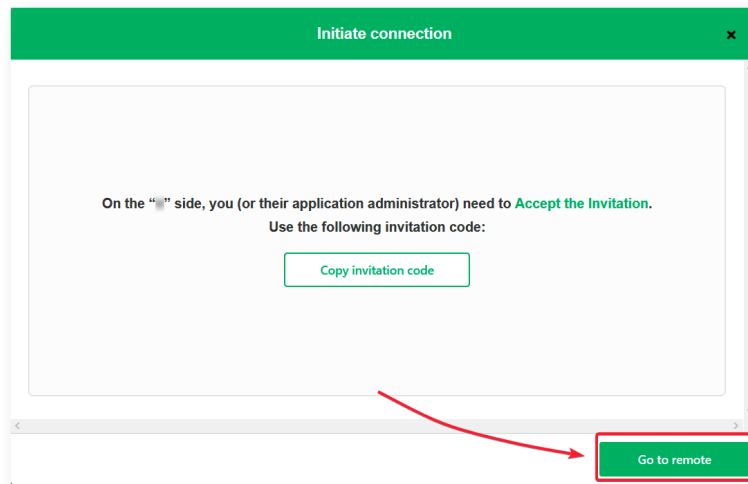

11. Click **Go to remote** to access the destination instance.

To finish setting up the connection, the partner needs to accept the connection invitation.

When the other side accepts your invitation your connection will be activated. Refresh the **Connections** page to see the Connection status change.

What's Next?

You need to accept the Connection Invitation on the platform you want to set up an integration with. Go to the **Connections** tab in the Exalate Admin console on that platform and click the **Accept Invitation** button. Then paste the invitation code you have copied above.

Product

ON THIS PAGE

[About Us](#)
[Release History](#)
[Initiate a Connection in Script Mode from Jira Cloud](#)
[Glossary](#)
[What's Next?](#)

[Privacy](#)

[Security](#)

[Pricing and Licensing](#)

Resources

[Academy](#)

[Blog](#)

[YouTube Channel](#)

[Ebooks](#)

Still need help?

[Join our Community](#)

[Visit our Service Desk](#)

[Find a Partner](#)