

How to Generate Personal Access Token for Azure DevOps

Last Modified on 03/13/2024 8:26 am EDT

This article shows you how to generate a Personal access token (PAT). Personal access tokens are used to log in to Exalate for Azure DevOps.

Note: Make sure that the user generating the PAT belongs to the **Project Collection Administrators** group. You can check this in **Organization Settings** → **Permissions**.

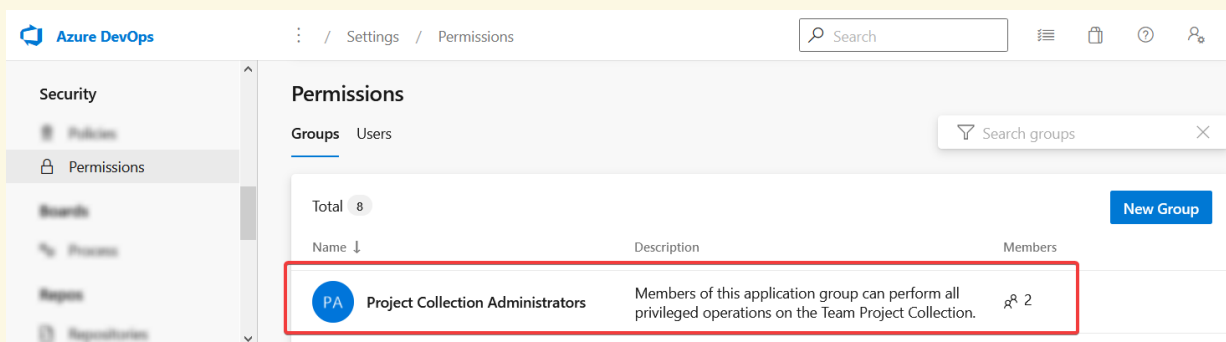

To generate an Azure DevOps personal access token:

1. Sign in to your organization in Azure DevOps:

```
https://dev.azure.com/{yourorganization}
```

2. Navigate to **User settings** → **Personal access tokens**.

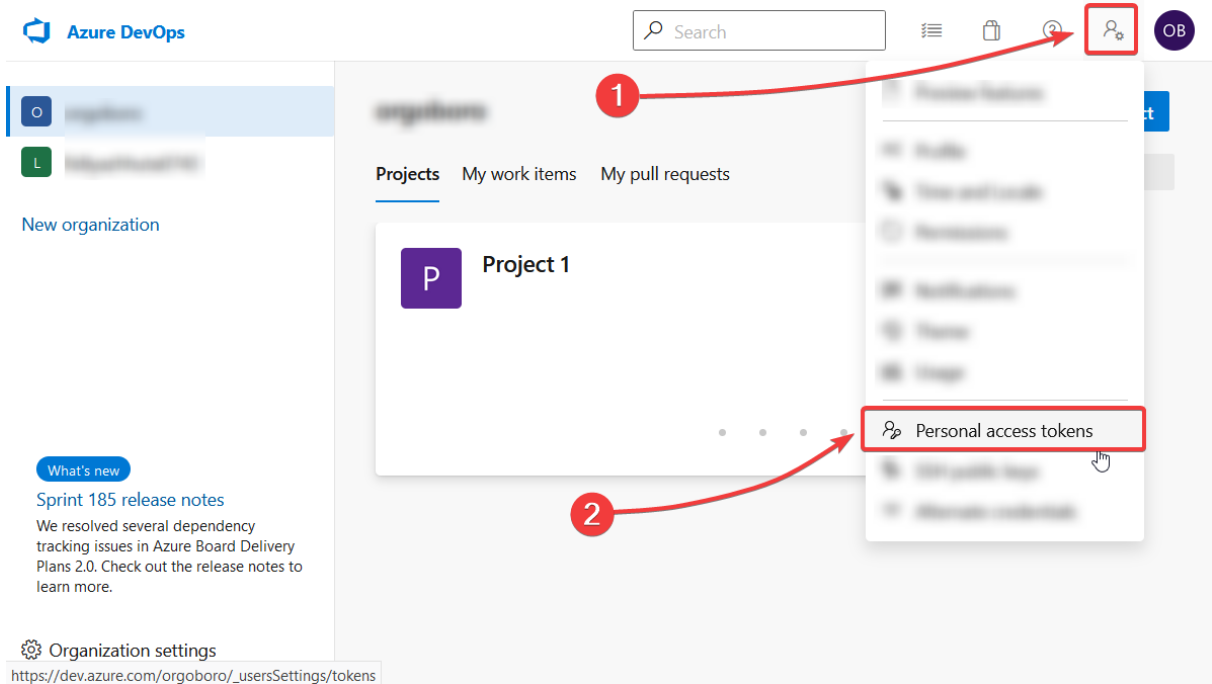

3. Click **New token**.

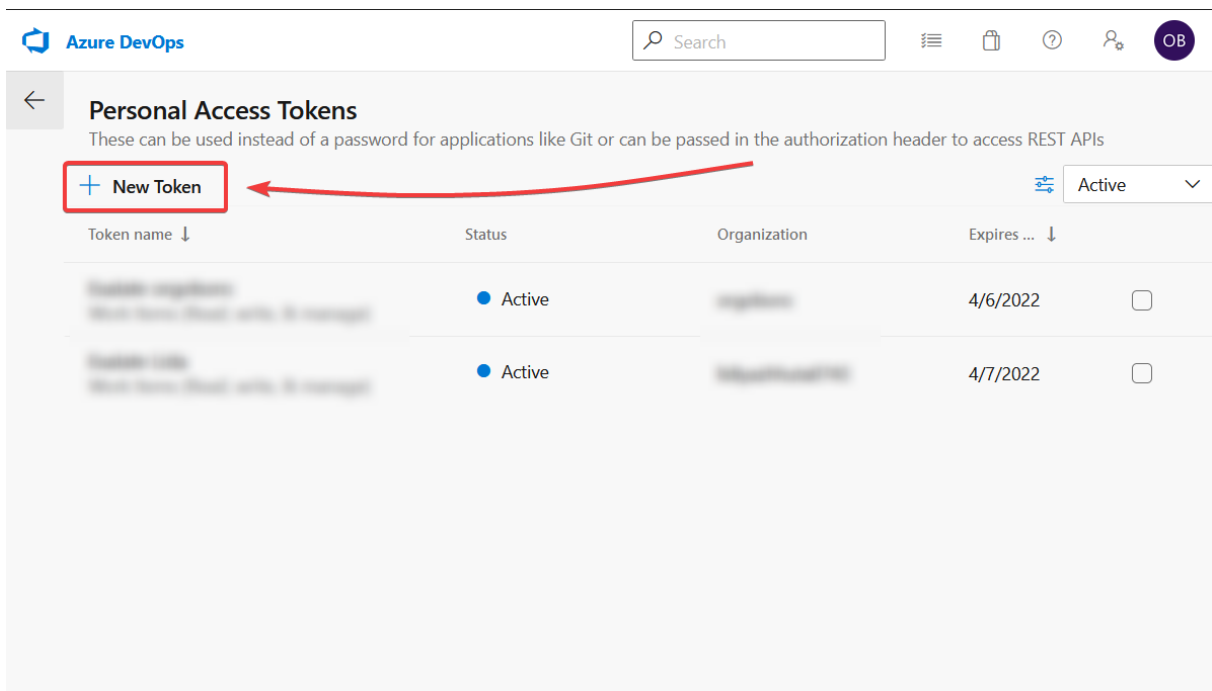

4. Choose the name for your token, select the organization where you want to use the token, and set the expiration date for the token.

Note: Set the longest expiration period for the token to keep it valid for as long as possible.

Create a new personal access token



Name

Organization

Expiration (UTC)

Scopes

Authorize the scope of access associated with this token

- Scopes Full access
 Custom defined

5. Select the following scopes:

- Work Items (vso.work) READ & WRITE
- Project and Team (vso.project) READ
- User Profile (vso.profile) READ
- Identity (vso.identity) READ
- Member Entitlement Management (vso.memberentitlementmanagement) READ

Note: Without this scope, Exalate is not able to sync work items.

1. Click **Create**.
2. Copy the token and save it for reuse in the future.

Success!



You have successfully added a new personal access token. Copy the token now!

Exalate token token

ad7uodzf67ol5ftd22ddg4gis

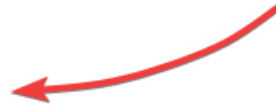

Warning - Make sure you copy the above token now. We don't store it and you will not be able to see it again.

Product

[About Us](#)

[Release History](#)

[Glossary](#)

[API Reference](#)

[Security](#)

[Pricing and Licensing](#)

Resources

[Academy](#)

[Blog](#)

[YouTube Channel](#)

[Ebooks](#)

Still need help?

[Join our Community](#)

[Visit our Service Desk](#)

[Find a Partner](#)

Close